

5 Valve Manifolds - 90° Angle and Straight Style

Standard Direct-Mount®

Compact Direct-Mount®

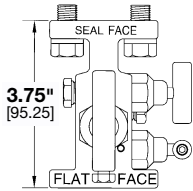

M3-775

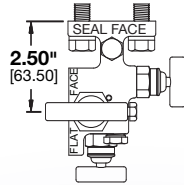
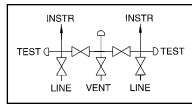

M3-875
(Patented)

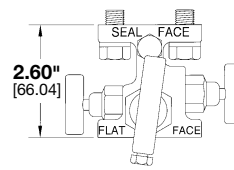
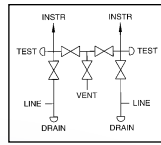

M3-873
(Patented)

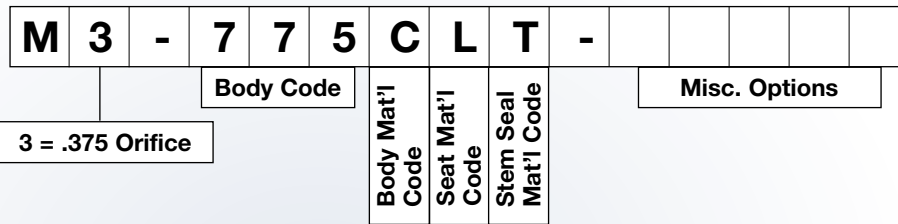
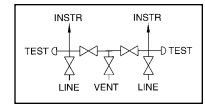

PART NUMBER	STANDARD	STANDARD	STANDARD
M3-775CLT	Wide-Pattern™ Straight Style	Carbon Steel w/CS Bolts	7.60 lbs.
M3-775SLT	Wide-Pattern™ Straight Style	316 SS w/CS Bolts	7.60 lbs.
M3-875CLT	90° Style	Carbon Steel w/CS Bolts	7.26 lbs.
M3-875SLT	90° Style	316 SS w/CS Bolts	7.10 lbs.
PART NUMBER	COMPACT	COMPACT	COMPACT
M3-873CLT	Straight Style	Carbon Steel w/CS Bolts	5.75 lbs.
M3-873SLT	Straight Style	316 SS w/CS Bolts	5.75 lbs.
OPTION CODE	DESCRIPTION		
SEAT MATERIAL OPTIONS – See Pressure and Temperature Charts on Page 3			
L	Rylon (Standard)		
D	Delrin®		
K	KEL-F®		
P	PEEK®		
T	Teflon®		
STEM SEAL MATERIAL OPTIONS – See Pressure and Temperature Charts on Page 3			
T	Patented Teflon® Pressure-Core® (Standard)		
J	Patented Teflon® Pressure-Core® (Low Temp)		
P	Teflon® Packed Style		
V	Viton® O-Ring		
MISCELLANEOUS OPTIONS			
MH	Viton® O-Ring Flange Seals (Teflon® Standard)		
MY	Dialectric Isolators for Manifold Flange		
W9	316 SS Bolts (CS Standard)		

MISCELLANEOUS OPTIONS & BOLT SELECTION CONTINUED ON PAGE 26



5 Valve Manifolds - 90° Angle and Straight Style (continued)

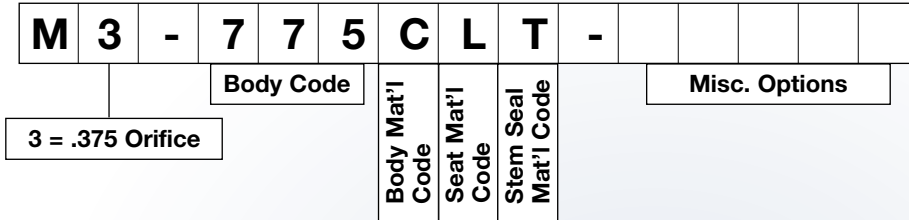

APPLICATION	BOLT LENGTH CODE	SELECTION CRITERIA
ΔP Transmitter Only	Blank 1" <small>[25.40]</small> (Standard)	Rosemount 1151, Honeywell 900, ΔP Only Traditional Style Transmitters (No Adapters)
	WA 2-1/4" <small>[57.15]</small>	Rosemount 3051C, 3051S or 2024 with Coplanar Flange ΔP Transmitters Only (No Adapters)
Flow Computer Only	Blank 1" <small>[25.40]</small> (Standard)	ABB Totalflow: XFC6413, 6713, 6200EX, 6213, MV2010 Bristol Inc: Teleflow Series, MVT Series, 2808 Series Cameron Measurement Systems: Scanner Series 1131 and MVX2-II Kimray: K500 ThermoFisher: AutoPilot, AutoMate, AutoMitter
	WA 2-1/4" <small>[57.15]</small>	Dynamic Flow Computers: E-Chart, E-Chart Plus, E-Chart Lite, MicroMV Emerson Process Management: FloBoss Series, Rosemount 2024, 3051S, 3095
ΔP and Static Transmitters with ΔP to Static Adapter	WC 2" <small>[50.80]</small>	ΔP Traditional Flange Transmitter used in combination with an AK-700 or AK-701 ΔP to Static Adapter
	WJ 3-1/4" <small>[82.55]</small>	ΔP Rosemount 3051C, 3051S or 2024 Transmitter with Coplanar used in Combination with an AK-700 or AK-701 ΔP to Static Adapter
Dual ΔP and Static Transmitters	WF 3" <small>[76.20]</small>	Rosemount 1151, Honeywell 900, etc. ΔP Traditional Flange Transmitter used in Combination with an AK-700 or AK-701 AND AK-054 or AK-112 (Bi-Directional/Dual Custody/Dual ΔP Installations)
Rosemount Dual ΔP & Static Transmitters	WP 4-1/4" <small>[107.95]</small>	Rosemount 3051C, 3051S or 2024 with Coplanar Flange ΔP Transmitters used in Combination with an AK-700 or AK-701 AND AK-054 or AK-112 (Bi-Directional/Dual Custody/Dual ΔP Installations)
MISCELLANEOUS OPTIONS		
	W9	316 SS Bolt Material (CS Standard)
	XL	Clean for Critical Service (Oxygen and Chlorine)