

# Bleeder Valves ~ Hard Seat

## ORIFICE

**.187"**

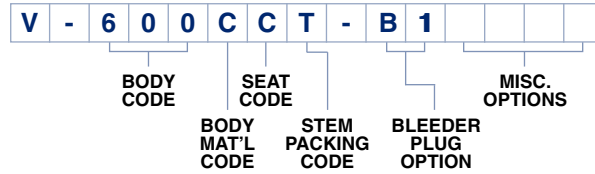

**V-600 Main Valve**

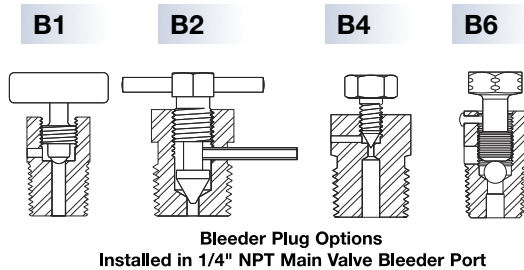
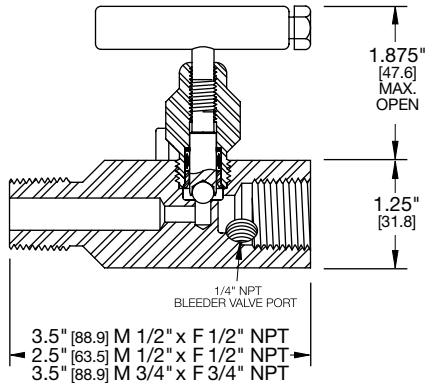

## ORDERING INFORMATION

PART NO.	CONNECTIONS		BODY & BONNET	MAIN VALVE SEAT & PACKING
	INLET	OUTLET		
<b>.187" Orifice</b>				
V-600CCT	1/2" MNPT x 1/2" FNPT	1/2" FNPT x 1/2" FNPT	Carbon Steel	Carbide Ball Seat  Teflon® <i>Pressure-Core</i> ® Stem Seal  Max Pressure 10,000 PSI @ 200°F
V-600SCT			316 SS	
V-602CCT	1/2" FNPT x 1/2" FNPT	1/2" FNPT x 1/2" FNPT	Carbon Steel	
V-602SCT			316 SS	
V-604CCT	3/4" MNPT x 1/2" FNPT	1/2" FNPT x 1/2" FNPT	Carbon Steel	
V-604SCT			316 SS	

## MAIN VALVE MATERIALS OF CONSTRUCTION

PART DESCRIPTION	MATERIALS OF CONSTRUCTION	
	CARBON STEEL	316 SS
Body and Bonnet	ASTM A108 CS	ASTM A479-316 SS
Stem	ASTM A479-316 SS	ASTM A479-316 SS
Seal Retainer	ASTM A479-316 SS	ASTM A479-316 SS
Handle Assembly	ASTM A108 CS	ASTM A581 18-8 300 SS

- PGI Carbon Steel Products are Alkaline Zinc plated for corrosion prevention.
- PGI 316 SS Products meet the requirements of NACE MR0175/ISO 15156-36.
- 100% Pressure Tested
- Carbon Steel Weld End Connection Bodies are AISI 1018

## VALVE MAX Cv RATINGS

ORIFICE SIZE	BODY STYLE
.187"	Straight .53
Approximate Weight of Main Valve: 1.60 lbs [0.73 kg] each	
Approximate Weight of Bleeder Plugs: See page 19.	

OPTION CODE	DESCRIPTION	
<b>Seat Material Options</b>		
R	Ceramic Ball Seat	Refer to Chart C on Page 22 and Pressure and Process Temperature Charts on Page 23.
6	316 SS Ball Seat	
<b>Stem Packing Material Options</b>		
T	Teflon® <i>Pressure-Core</i> ® Stem Seal	Refer to Charts C and E on Page 22 and Pressure and Process Temperature Charts on Page 23.
J	Teflon® <i>Pressure-Core</i> ® Stem Seal (Low Temperature -50°F)	
<b>Bleeder Plug Options</b>		
Installed in 1/4" NPT Bleed Port Bleeder Valve Body is same material as Main Valve.		
B1	Carbide Ball Bleeder Plug Model A7-521	Max Pressure 10,000 PSI @ 200°F
B2	Bleed-T Plug Model A7-528	
B4	Mini-Hex Bleeder Plug Model A7-525	
B6	SS Ball Bleed Plug Model BV10N4	
<b>Miscellaneous Options</b>		
AM7	Male Pipe Socket Weld - Male Inlet Only	
M1	Panel Mount	
W	Safety Bonnet Lock Plate (Lock Pin Standard)	
W1	316 SS Tag	
WK	Paper Tag	
XL	Clean for Critical Service (Oxygen or Chlorine)	

# Bleeder Valves and Plugs

## ORDERING INFORMATION

### Bleed "T" Valves

PART NO.	CONNECTIONS	BODY & STEM	SEAT	BLEED "T" PLUG
V-597-10	1/2" MNPT x (2) 1/2" FNPT	A108-1215 CS / A479-316 SS	Integral Metal	A108-1215 CS
V-597-C0		A479-316 SS		A479-316 SS
B8-597-10	1/2" MNPT x (3) 1/2" FNPT	A108-1215 CS / A479-316 SS		None
B8-597-C0		A479-316 SS		None
V-598-10	3/4" MNPT x (2) 1/2" FNPT	A108-1215 CS / A479-316 SS		A108-1215 CS
V-598-C0		A479-316 SS		A479-316 SS
B8-598-10	3/4" MNPT x (3) 1/2" FNPT	A108-1215 CS / A479-316 SS	None	
B8-598-C0		A479-316 SS	None	

**MAX Cv Rating:** .125      **Approximate Weight:** 1.00 lbs [0.45 kg] each  
**Carbon Steel:** 10,000 PSI @ 200°F or 1,500 PSI @ 800°F  
**316 SS:** 10,000 PSI @ 200°F or 1,500 PSI @ 1,000°F

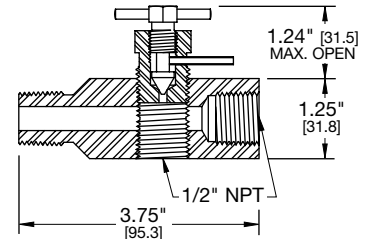

### Bleed "T" Plugs B6

PART NO.	CONNECTIONS	BODY & STEM	SEAT
BV10N2-10	1/4" MNPT	ASTM A108-1215 CS / ASTM A479-316 SS	Carbide Ball
BV10N2-C0		ASTM A479-316 SS / ASTM A479-316 SS	
BV10N4-10	1/2" MNPT	ASTM A108-1215 CS / ASTM A479-316 SS	
BV10N4C0		ASTM A479-316 SS / ASTM A479-316 SS	

**Approximate Weight:** .50 lbs [0.23 kg] each  
**Carbon Steel:** 10,000 PSI @ 200°F or 1,500 PSI @ 500°F  
**316 SS:** 10,000 PSI @ 200°F or 1,500 PSI @ 1,000°F

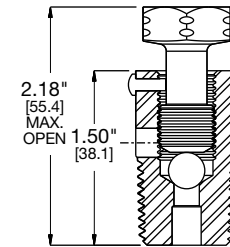

### Bleed "T" Plugs B2

PART NO.	CONNECTIONS	BODY & STEM	SEAT
A7-528-10	1/4" MNPT	ASTM A108-1215 CS / ASTM A479-316 SS	410 SS Ball
A7-528-C0		ASTM A479-316 SS / ASTM A479-316 SS	
A7-529-10	1/2" MNPT	ASTM A108-1215 CS / ASTM A479-316 SS	
A7-529-C0		ASTM A479-316 SS / ASTM A479-316 SS	

**MAX Cv Rating:** .125      **Approximate Weight:** .50 lbs [0.23 kg] each  
**Carbon Steel:** 10,000 PSI @ 200°F or 1,500 PSI @ 500°F  
**316 SS:** 10,000 PSI @ 200°F or 1,500 PSI @ 1,000°F

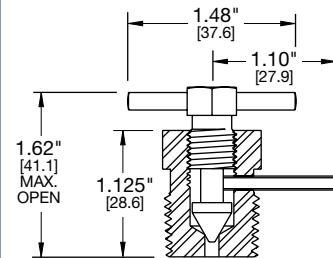

### Carbide Ball Bleed Plugs B1

PART NO.	CONNECTIONS	BODY & STEM	SEAT
A7-521-10	1/4" MNPT	ASTM A108-1215 CS / ASTM A479-316 SS	Carbide Ball
A7-521-C0		ASTM A479-316 SS / ASTM A479-316 SS	
A7-520-10	1/2" MNPT	ASTM A108-1215 CS / ASTM A479-316 SS	
A7-520-C0		ASTM A479-316 SS / ASTM A479-316 SS	

**Approximate Weight:** .50 lbs [0.23 kg] each  
**Carbon Steel:** 10,000 PSI @ 200°F or 1,500 PSI @ 500°F  
**316 SS:** 10,000 PSI @ 200°F or 1,500 PSI @ 1,000°F

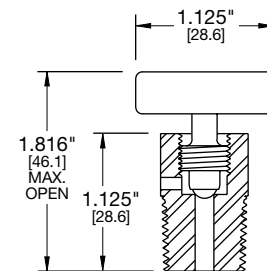

### Mini-Hex Bleed Plugs B4

PART NO.	CONNECTIONS	BODY & BLEED SCREW	SEAT
A7-525-10	1/4" MNPT	ASTM A108-1215 CS / 17-4 PH	Integral Metal
A7-525-C0		ASTM A479-316 SS / 17-4 PH	
A7-526-10	1/2" MNPT	ASTM A108-1215 CS / 17-4 PH	
A7-526-C0		ASTM A479-316 SS / 17-4 PH	

**Approximate Weight:** .30 lbs [0.14 kg] each  
**Carbon Steel:** 10,000 PSI @ 200°F or 1,500 PSI @ 500°F  
**316 SS:** 10,000 PSI @ 200°F or 1,500 PSI @ 1,000°F

