

Multi-Port Gauge Valves ~ Soft Seat

ORIFICE

.187" .250"



ORIFICE
BLANK = .187"
2 = .250"

BODY CODE

SEAT CODE

BODY MAT'L CODE

STEM PACKING CODE

MISC. OPTIONS

V-521

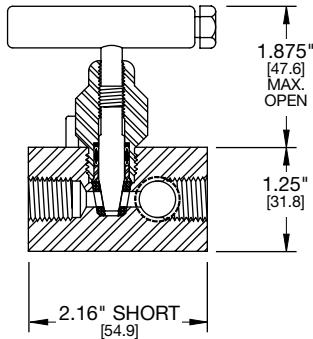

V-517

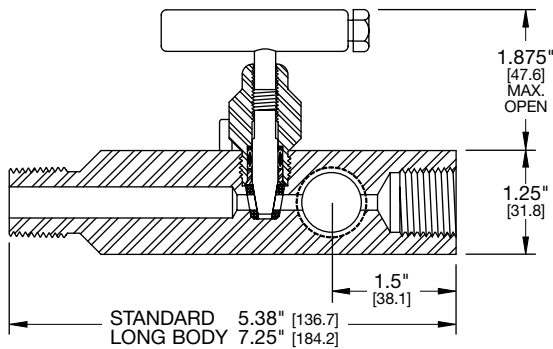

MATERIALS OF CONSTRUCTION

PART DESCRIPTION	CARBON STEEL	316 SS
Body and Bonnet	ASTM A108 CS	ASTM A479-316 SS
Stem	ASTM A479-316 SS	ASTM A479-316 SS
Seal Retainer	ASTM A479-316 SS	ASTM A479-316 SS
Handle Assembly	ASTM A108 CS	ASTM A581 18-8 300 SS

- PGI Carbon Steel Products are Alkaline Zinc plated for corrosion prevention.
- PGI 316 SS Products meet the requirements of NACE MR0175/ISO 15156-36.
- 100% Pressure Tested
- Carbon Steel Weld End Connection Bodies are AISI 1018

MAX Cv RATINGS

ORIFICE SIZE	BODY STYLE Straight
.187"	.83
.250"	1.40

Approximate Valve Weight: 1.00 lb [0.45 kg] each (Short)
2.30 lbs [1.04 kg] each (Standard)
3.00 lbs [1.36 kg] each (Longbody)

ORDERING INFORMATION

PART NO.	CONNECTIONS INLET OUTLET	BODY & BONNET	SEAT & PACKING	
.187" Orifice				
V-521CDT	1/4" FNPT x (3) 1/4" FNPT Short	Carbon Steel	Delrin® Cone Seat	
V-521SDT	Standard	316 SS		
V-517CDT	1/2" MNPT x (3) 1/2" FNPT Standard	Carbon Steel		
V-517SDT	Standard	316 SS		
V-519CDT	3/4" MNPT x (3) 1/2" FNPT Standard	Carbon Steel	Teflon® Pressure-Core® Stem Seal	
V-519SDT	Standard	316 SS		
V-573CDT	1/2" MNPT x (3) 1/2" FNPT Longbody	Carbon Steel		
V-573SDT	Standard	316 SS		
V-574CDT	3/4" MNPT x (3) 1/2" FNPT Longbody	Carbon Steel	Max Pressure 6,000 PSI @ 200°F	
V-574SDT	Standard	316 SS		
.250" Orifice				
V2-517CDT	1/2" MNPT x (3) 1/2" FNPT Standard	Carbon Steel		
V2-517SDT	Standard	316 SS		
V2-519CDT	3/4" MNPT x (3) 1/2" FNPT Standard	Carbon Steel		
V2-519SDT	Standard	316 SS		

OPTION CODE	DESCRIPTION	
Seat Material Options		
K	Kel-F® Seat	Refer to Chart B on Page 22 and Pressure and Process Temperature Charts on Page 23.
P	PEEK® Seat	
T	Teflon® Seat	
Z	Tefzel® Seat	
Stem Packing Materials Options		
T	Teflon® Pressure-Core® Stem Seal	
J	Teflon® Pressure-Core® Stem Seal (Low Temperature -50°F)	
Miscellaneous Options		
AM7	Male Pipe Socket Weld - Male Inlet Only	
W	Safety Bonnet Lock Plate (Lock Pin Standard)	
W1	316 SS Tag	
WK	Paper Tag	
XL	Clean for Critical Service (Oxygen or Chlorine)	

Multi-Port Gauge Valves ~ Soft Seat

ORIFICE

.375"

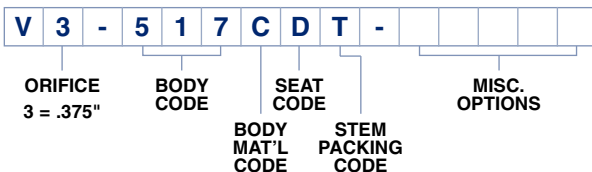

ORDERING INFORMATION

PART NO.	CONNECTIONS		BODY & BONNET	SEAT & PACKING
	INLET	OUTLET		
.375" Orifice				
V3-517CDT	1/2" MNPT	(3) 1/2" FNPT	Carbon Steel	Delrin® Cone Seat
V3-517SDT	Standard		316 SS	
V3-519CDT	3/4" MNPT	(3) 1/2" FNPT	Carbon Steel	Teflon® Pressure-Core® Stem Seal
V3-519SDT	Standard		316 SS	
V3-577CDT	1" MNPT	(3) 1/2" FNPT	Carbon Steel	Max Pressure 6,000 PSI @ 200°F
V3-577SDT	Standard		316 SS	

OPTION CODE	DESCRIPTION	
Seat Material Options		
K	Kel-F® Seat	Refer to Charts D and E on Page 22 and Pressure and Process Temperature Charts on Page 23.
L	Rylon™ Seat	
P	PEEK® Seat	
T	Teflon® Seat	
6	316 SS Seat	
Stem Packing Material Options		
T	Teflon® Pressure-Core® Stem Seal	
G	Low-Torque™ Grafoil® Packed (Available with 316 SS Cone Only)	
J	Teflon® Pressure-Core® Stem Seal (Low Temperature -50°F)	
Miscellaneous Options		
AM7	Male Pipe Socket Weld - Male Inlet Only	
W	Safety Bonnet Lock Plate (Lock Pin Standard)	
W1	316 SS Tag	
WK	Paper Tag	
XL	Clean for Critical Service (Oxygen or Chlorine)	

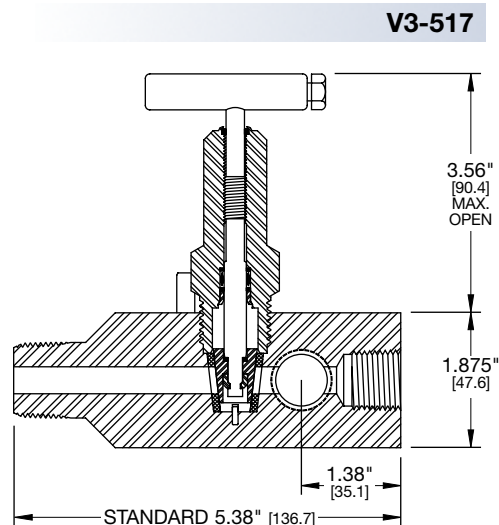

MATERIALS OF CONSTRUCTION

PART DESCRIPTION	CARBON STEEL	316 SS
Body and Bonnet	ASTM A108 CS	ASTM A479-316 SS
Stem	ASTM A479-316 SS	ASTM A479-316 SS
Seal Retainer	ASTM A479-316 SS	ASTM A479-316 SS
Handle Assembly	ASTM A108 CS	ASTM A581 18-8 300 SS

- PGI Carbon Steel Products are Alkaline Zinc plated for corrosion prevention.
- PGI 316 SS Products meet the requirements of NACE MR0175/ISO 15156-36.
- 100% Pressure Tested
- Carbon Steel Weld End Connection Bodies are AISI 1018

MAX Cv RATINGS

ORIFICE SIZE	BODY STYLE
	Straight
.375"	3.00
Approximate Valve Weight: 2.30 lbs [1.04 kg] each	

MULTI-PORT GAUGE VALVES

Multi-Port Gauge Valves ~ Hard Seat

ORIFICE

.187"

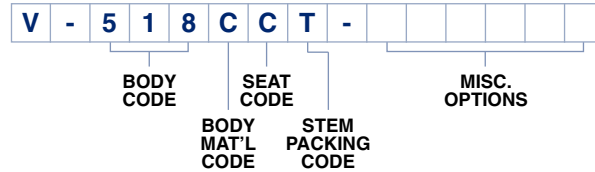

ORDERING INFORMATION

V-518

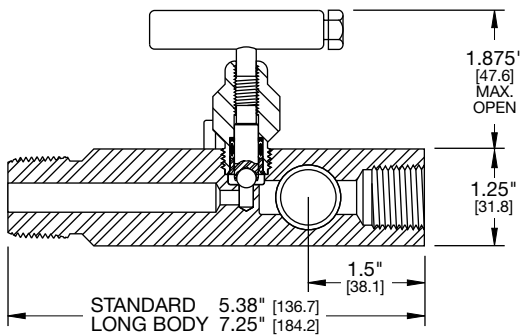

PART NO.	CONNECTIONS		BODY & BONNET	SEAT	PACKING
	INLET	OUTLET			
.187" Orifice					
V-516CCT	1/2" MNPT x (3) 1/2" FNPT Standard		Carbon Steel	Carbide Ball	Teflon® Pressure-Core® Stem Seal
V-516SCT			316 SS	Monel® Ball	
V-516MNT			Monel®		
V-518CCT	3/4" MNPT x (3) 1/2" FNPT Standard		Carbon Steel	Carbide Ball	
V-518SCT			316 SS	Monel® Ball	
V-518MNT			Monel®		
V-520CCT	1/2" MNPT x (3) 1/2" FNPT Longbody		Carbon Steel	Carbide Ball	Max Pressure 10,000 PSI @ 200°F
V-520SCT			316 SS		
V-532CCT	3/4" MNPT x (3) 1/2" FNPT Longbody		Carbon Steel		
V-532SCT			316 SS		

OPTION CODE	DESCRIPTION
Body Material Options	
P	ASTM A105 CF Carbon Steel For Use with Grafoil® Packed Bonnets
Seat Material Options	
N	Monel® Ball Seat
R	Ceramic Ball Seat
6	316 SS Ball Seat
Stem Packing Material Options	
T	Teflon® Pressure-Core® Stem Seal
G	Low-Torque™ Grafoil® Packed
J	Teflon® Pressure-Core® Stem Seal (Low Temperature -50°F)
Miscellaneous Options	
AM7	Male Pipe Socket Weld - Male Inlet Only
S1	Monel Stem Material
W	Safety Bonnet Lock Plate (Lock Pin Standard)
W1	316 SS Tag
WK	Paper Tag
XL	Clean for Critical Service (Oxygen or Chlorine)

Refer to Charts C and E on Page 22 and Pressure and Process Temperature Charts on Page 23.

MATERIALS OF CONSTRUCTION

PART DESCRIPTION	CARBON STEEL	316 SS
Body and Bonnet	ASTM A108 CS	ASTM A479-316 SS
Stem	ASTM A479-316 SS	ASTM A479-316 SS
Seal Retainer	ASTM A479-316 SS	ASTM A479-316 SS
Handle Assembly	ASTM A108 CS	ASTM A581 18-8 300 SS

- PGI Carbon Steel Products are Alkaline Zinc plated for corrosion prevention.
- PGI 316 SS Products meet the requirements of NACE MR0175/ISO 15156-36.
- 100% Pressure Tested
- Carbon Steel Weld End Connection Bodies are AISI 1018

MAX Cv RATINGS

ORIFICE SIZE	BODY STYLE
.187"	Straight
	.53

Approximate Valve Weight: 2.30 lbs [1.04 kg] each (Standard)
3.00 lbs [1.36 kg] each (Longbody)

Multi-Port Gauge Valves ~ Hard Seat

ORIFICE

.375"

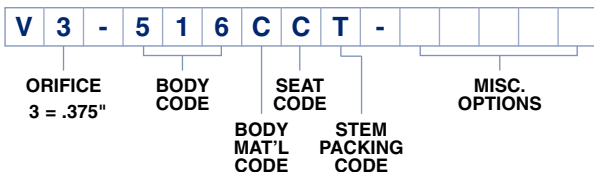

ORDERING INFORMATION

PART NO.	CONNECTIONS		BODY & BONNET	SEAT & PACKING
	INLET	OUTLET		
.375" Orifice				
V3-516CCT	1/2" MNPT	(3) 1/2" FNPT	Carbon Steel	Carbide Ball Seat Teflon® Pressure-Core® Stem Seal
V3-516SCT	Standard	Standard	316 SS	
V3-518CCT	3/4" MNPT	(3) 1/2" FNPT	Carbon Steel	Refer to page 22 Press./Temp. Chart C.
V3-518SCT	Standard	Standard	316 SS	
V3-516PCG	1/2" MNPT	(3) 1/2" FNPT	Carbon Steel	Carbide Ball Seat Grafoil® Packed Refer to page 22 Press./Temp. Chart E.
V3-516SCG	Standard	Standard	316 SS	
V3-518PCG	3/4" MNPT	(3) 1/2" FNPT	Carbon Steel	
V3-518SCG	Standard	Standard	316 SS	
V3-520PCG	1/2" MNPT	(3) 1/2" FNPT	Carbon Steel	
V3-520SCG	Longbody	Longbody	316 SS	
V3-532PCG	3/4" MNPT	(3) 1/2" FNPT	Carbon Steel	
V3-532SCG	Longbody	Longbody	316 SS	

OPTION CODE	DESCRIPTION
Body Material Options	
P	ASTM A105 CF Carbon Steel <i>For Use with Grafoil® Packed Bonnets</i>
Seat Material Options	
R	Ceramic Ball Seat
6	316 SS Ball Seat
Stem Packing Material Options	
T	Teflon® Pressure-Core® Stem Seal
G	Low-Torque™ Grafoil® Packed
J	Teflon® Pressure-Core® Stem Seal (Low Temperature -50°F)
Miscellaneous Options	
AM7	Male Pipe Socket Weld - Male Inlet Only
W	Safety Bonnet Lock Plate (Lock Pin Standard)
W1	316 SS Tag
WK	Paper Tag
XL	Clean for Critical Service (Oxygen or Chlorine)

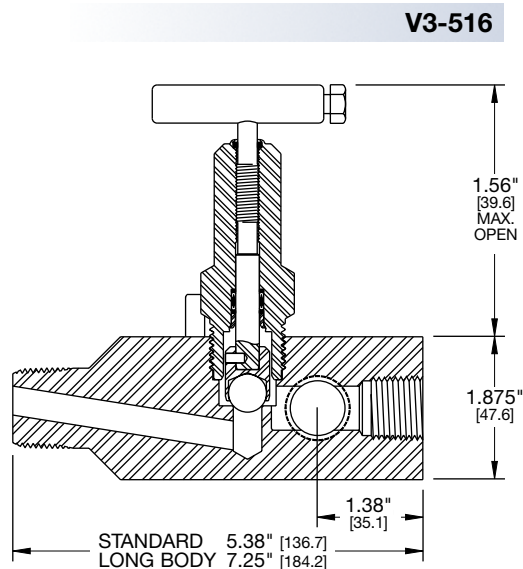

MATERIALS OF CONSTRUCTION

PART DESCRIPTION	CARBON STEEL	316 SS
Body and Bonnet	ASTM A108 CS	ASTM A479-316 SS
Stem	ASTM A479-316 SS	ASTM A479-316 SS
Seal Retainer	ASTM A479-316 SS	ASTM A479-316 SS
Handle Assembly	ASTM A108 CS	ASTM A581 18-8 300 SS

- PGI Carbon Steel Products are Alkaline Zinc plated for corrosion prevention.
- PGI 316 SS Products meet the requirements of NACE MR0175/ISO 15156-36.
- 100% Pressure Tested
- Carbon Steel Weld End Connection Bodies are AISI 1018

MAX Cv RATINGS

ORIFICE SIZE	BODY STYLE
.375"	Straight
	2.40
Approximate Valve Weight: 2.30 lbs [1.04 kg] each (Standard) 3.00 lbs [1.36 kg] each (Longbody)	